



Stainless Steel Pumps

Model BEST ONE Domestic Submersible Sump Pumps

Best One MA
Automatic pump with Float Switch

All Stainless Steel with Mechanical seal



Domestic sump pump manufactured in 304 stainless steel and with a mechanical shaft seal for reliability. Suitable for many dewatering usages, including:- draining wells, basements, cellars, etc. emptying of tanks & drums general transfer of clean water.

Performance Curve

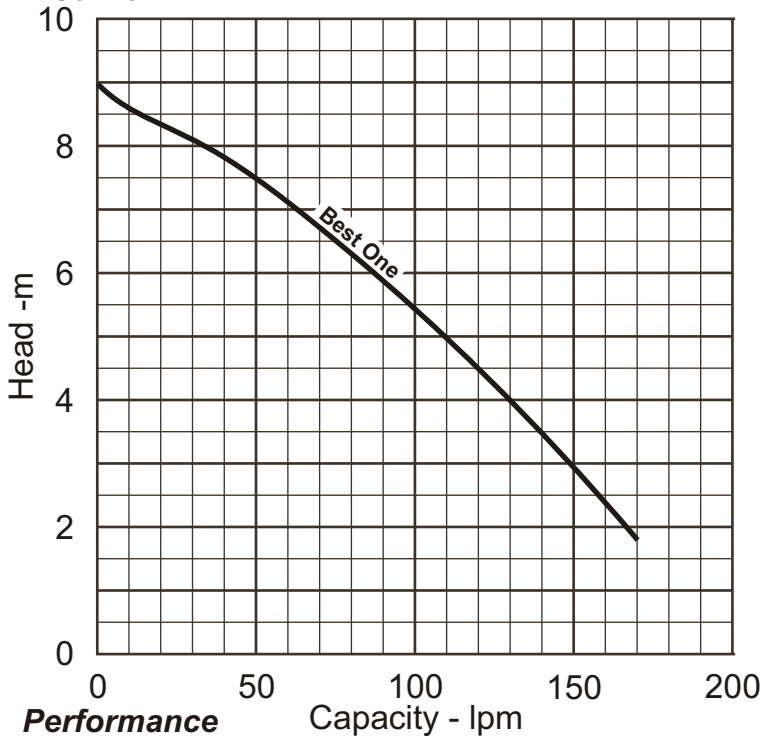

Performance Table

Pump Model	Motor Output	Discharge Ø mm	Power Supply	Full Load Current	Capacitor (1Phase models only)	Q= Capacity - litres/min						
						0	20	40	80	120	160	170
Best One	0.25 kW	32 mm	240V, 50Hz, 1Ph	2.3 A	8µF	H=Total Head - metres (m)						
						9.0	8.3	7.8	6.3	4.5	2.4	1.8

Specifications

Submersible pump with semi open impeller
Maximum solids handling 10 mm
Maximum liquid temperature: 50°C
Maximum submergence: 5m

Materials

Pump casing: 304 Stainless Steel
Impeller: 304 Stainless Steel
Outer casing: 304 Stainless Steel
Shaft : 303 Stainless Steel
Motor frame: 304 Stainless Steel
Motor Cap: 304 Stainless Steel
Fasteners: 304 Stainless Steel
Seal: Carbon/Ceramic Mechanical Seal in oil lubricated chamber, Upper Lip Seal

Motor Data

Air filled, dry submersible, 2 pole motor
Insulation class F
IP68 protection
50 Hz, 1 phase, 240 Volt
In built overload protection

Cable

5 m of cable (with plug)

Range

32mm discharge
0.25 kW motor
Single phase, automatic or manual versions
Magnetic Switch version available

Options



Best One MS
Automatic pump with Magnetic Switch



Best One M
Manual Pump



Low level suction "skirt" (down to 3mm)



(for manual model)

Sectional Drawing

Model **Best One**

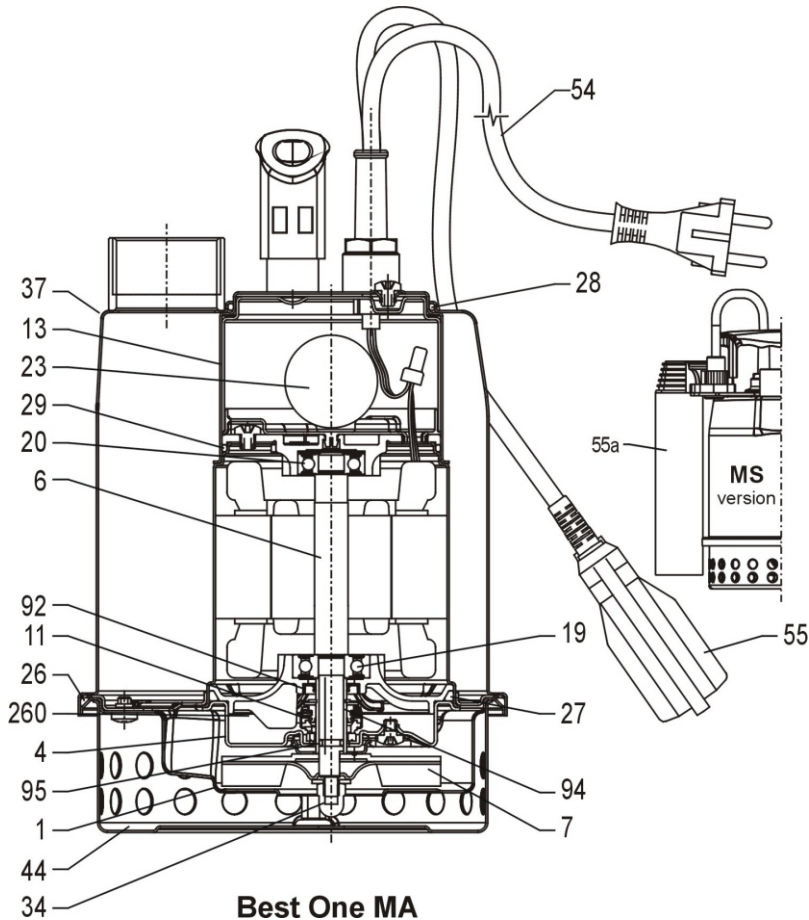

Item Number	Description	Material	Quantity per unit
1	Casing	AISI 304 Stainless Steel	1
4	Casing Cover	AISI 304 Stainless Steel	1
6	Shaft with rotor #	AISI 303 Stainless Steel	1
7	Impeller	AISI 304 Stainless Steel	1
11	Mechanical Seal	Carbon/Ceramic/NBR	1
13	Motor Cover	AISI 304 Stainless Steel	1
19	Lower Bearing	Sealed Ball Bearing	1
20	Upper Bearing	Sealed Ball Bearing	1
23	Capacitor		1
26	O' Ring	NBR Rubber	1
27	O' Ring	NBR Rubber	1
28	O' Ring	NBR Rubber	1
29	O' Ring	NBR Rubber	1
34	Impeller Nut	AISI 303 Stainless Steel	1
37	Outer Casing	AISI 304 Stainless Steel	1
44	Strainer	AISI 304 Stainless Steel	1
54	Submersible Power Cable		1
55	Float Switch	(for MA version only)	1
55a	Float Switch	(for MS version only)	1
92	Lip Seal	NBR Rubber	1
94	Shaft Sleeve	Ceramic coated 303 SS	1
95	O' Ring	NBR Rubber	1
260	Oil	Esso MARCOL 172	40cc

refers to pump side of shaft material

Dimensions

Model **Best One**

Units: mm unless otherwise specified

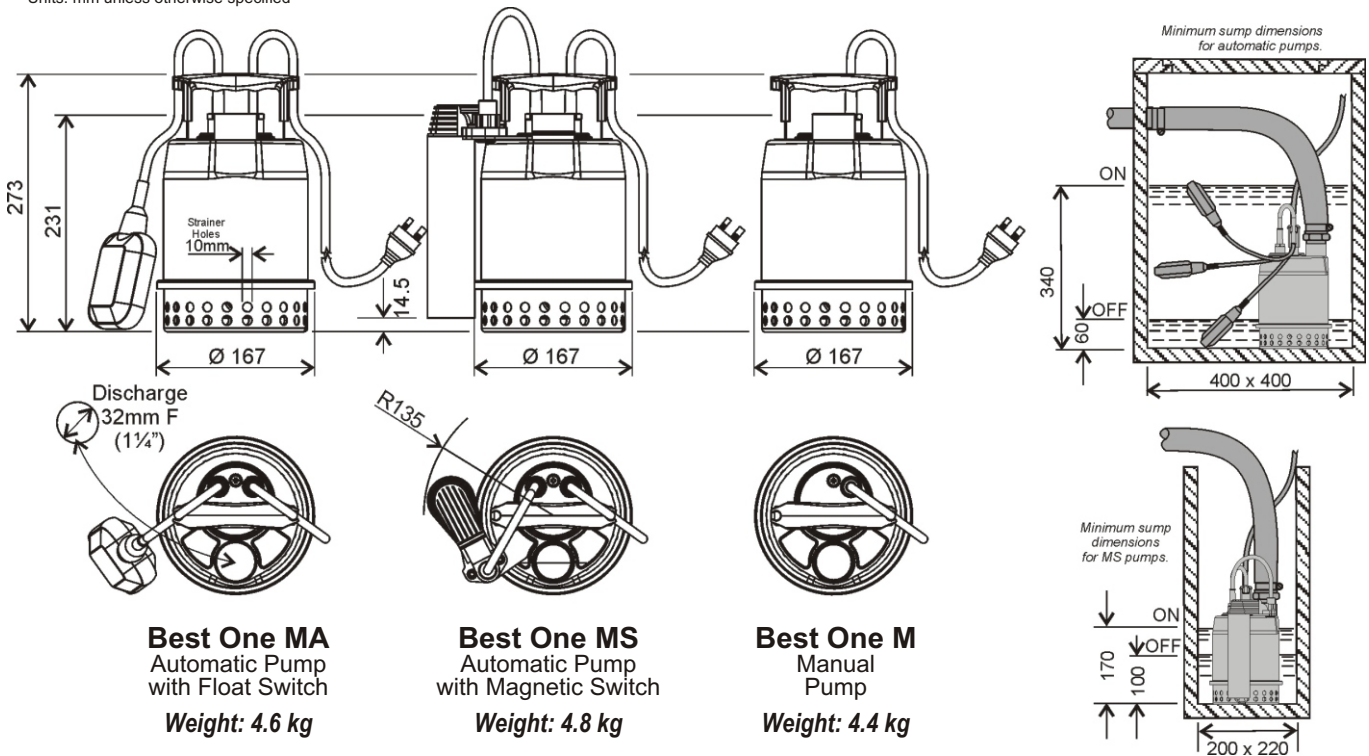

Best One MA
Automatic Pump
with Float Switch
Weight: 4.6 kg

Best One MS
Automatic Pump
with Magnetic Switch
Weight: 4.8 kg

Best One M
Manual
Pump
Weight: 4.4 kg

Specifications subject to change without notice